

YACHT FACILITIES

YACHT AMENITIES

Individual stateroom thermostats
 Medical Facility
 Open seating dining indoors and outdoors
 24-Hour Room Service
 Electric current: 110/220 AC
 Elevator (Decks 2-5)
 Casino
 - Blackjack/Poker
 Thai-Certified Spa
 - Massage room
 - Steam Shower
 - Sauna
 Fitness Center with state-of-the-art equipment
 Outdoor private massage areas
 Outdoor whirlpools
 Water Sports Marina
 Beauty Salon

Laundry/dry cleaning
 Library with computers
 SeaDream Boutique
 Wi-Fi*

TECHNICAL FACILITIES

SOLAS 2005
 Fire Safety Standards

ACTIVITIES EQUIPMENT

Golf Simulator
 Mountain bikes
 Personal Watercraft (PWC)
 Kayaks
 Personal Sailboats
 Hobie Cats™ Catamarans
 Banana Boat
 Zodiac motor boats
 Tube, Water skis and wake boards
 Snorkeling gear
 Wave Runners/Jet Skis
 Balinese Dream Beds

Card Room
 Stand-up Paddleboards
 SeaDream Floating Island & Trampoline

ALL STATEROOMS PROVIDE

Ocean view
 Refrigerator stocked with beer, soft drinks and water
 Organic bath amenities
 Private safe
 Hair dryer
 USB/USBC Charging ports
 Wi-Fi*
 Personalized yacht stationery
 55-inch LED TV with Infotainment system
 Direct-dial telephone
 24-hour Menu
 Multi-jet shower massage
 Luxurious SeaDream logo bathrobes and slippers
 110/220 volt outlets

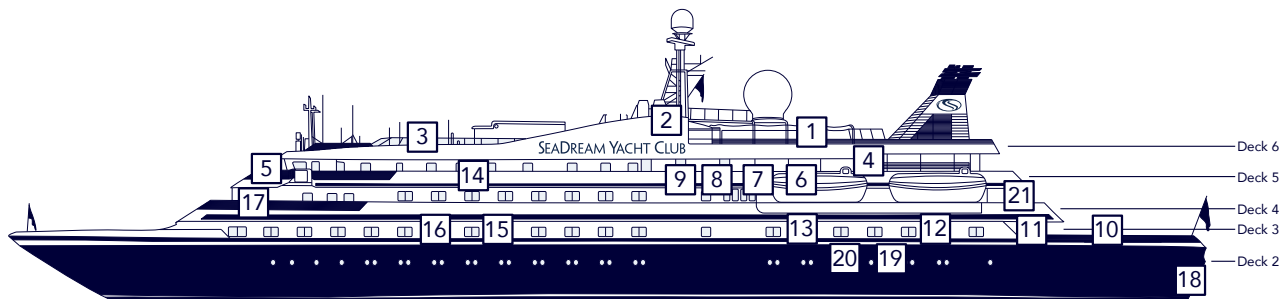

- | | |
|----------------------------------|--|
| 1. Top of The Yacht Bar Deck 6 | 12. Main Salon Deck 3 |
| 2. Golf Simulator Deck 6 | 13. Concierge/SeaDream Boutique Deck 3 |
| 3. Twin Jacuzzis/Sun Deck Deck 6 | 14. Yacht Club Staterooms Decks 2, 3, 4 |
| 4. Topside Restaurant Deck 5 | 15. Commodore Suite Decks 2, 3 |
| 5. Bridge Deck 5 | 16. Owner's Suite Deck 3 |
| 6. Library Deck 4 | 17. SeaDream Spa / Fitness Center Deck 4 |
| 7. Piano Bar Deck 4 | 18. Water Sports Marina Deck 2 |
| 8. Casino Deck 4 | 19. Dining Salon Deck 2 |
| 9. Admiral Suite Deck 4 | 20. Meeting Room Deck 2 |
| 10. Pool/Jacuzzi Deck 3 | 21. Lounging Area Deck 4 |
| 11. Pool Bar Deck 3 | |

*Internet access is available at an established charge

DECK PLANS

All staterooms and suites have ocean views

Owner's Suite
 Admiral Suite
 Convertible to Commodore Suites
 Yacht Club Staterooms

E Elevator

2 DECK

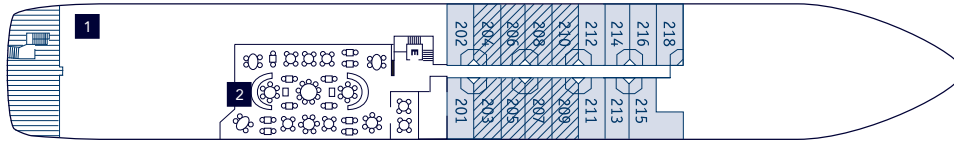

1. Retractable Water Sports Platform Marina 2. Dining Salon / Meeting Room

3 DECK

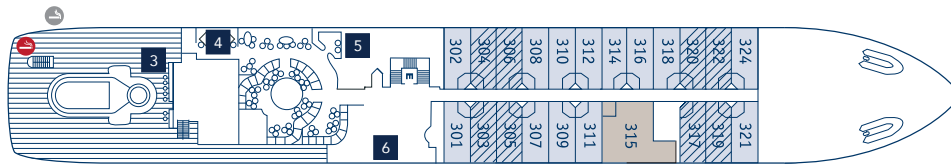

3. Pool Bar 4. Card Room 5. Main Salon / Main Salon Bar 6. Concierge

4 DECK

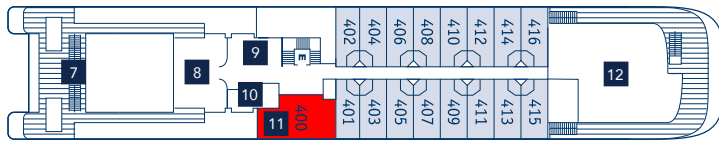

7. Lounging Deck 8. Library 9. Piano Bar 10. Casino 11. Admiral Suite 12. SeaDream Spa - Fitness Center - Beauty Salon

5 DECK

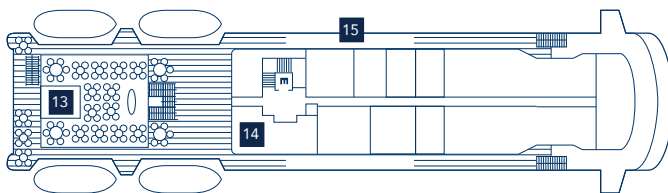

13. Topside Restaurant 14. Medical Facility 15. Open Promade

6 DECK

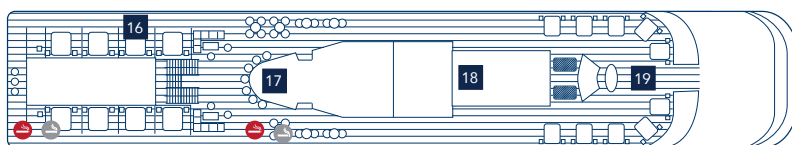

16. Balinese Dream Beds 17. Top of the Yacht Bar 18. Golf Simulator 19. Sun Beds

Smoking Area



STATEROOMS & SUITES

OWNER'S SUITE This premium suite (447 sq. ft. / 41.53 sq. meters) includes a thoughtfully appointed separate master bedroom suite with a permanent queen size bed and flat-screen TV. Large master bathroom with massage shower and separate soaking tub with views of the sea. Enjoy a spacious living and dining area with flat-screen TV, writing desk and ½ guest bath. The Owner's Suite is suite number 315 on both yachts, located mid ship on Deck 3, close to the pool.

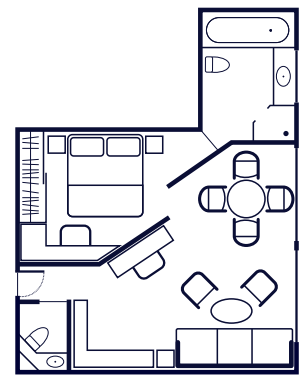

COMMODORE SUITE Combine two Yacht Club Staterooms to create a Commodore Suite. These comfortably appointed ocean view suites provide a choice of two twin beds or a queen size bed, two full marbled-lined baths with multi-jet showers, a seating area with sofa, coordinated chair and cocktail table, 2 spacious closets and built in dressers with writing desk. Configuration allows for either an additional permanent queen bed or dining area. There are eight possible Commodore Suites and they average 390 spacious sq. ft. / 36.23 sq. meters.

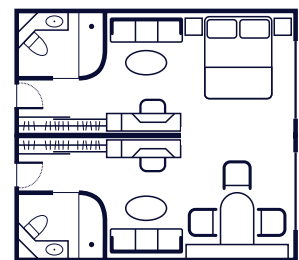



ADMIRAL SUITE Enjoy 375 sq. ft. / 34.8 sq. meters of living space with ocean views from a total of 3 picture windows. Partitioned living and dining areas with ½ guest bath and closet. Separate and private en-suite master bedroom with permanent queen bed and closet. Marble-lined bathroom with multi-jet shower and soaking tub. Built-in dresser with writing desk.

The Admiral Suite is Suite number 400 on both yachts and located near the Library.

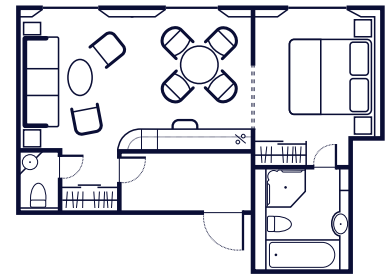

YACHT CLUB STATEROOM Deck 2, 3 and 4 average 195 sq.ft./18.12 sq. meters. These ocean view staterooms with picture windows (two round windows, deck 2) include a marble-lined bath with multi-jet shower and a well-appointed open living area with sofa, chair, cocktail table, and built-in dresser with writing desk. Ample closet space. Choice of 2 twin beds or 1 queen bed.

