

Regent

SEVEN SEAS CRUISES

AN UNRIVALLED EXPERIENCE™

CRUISE LOUNGE
Luxus- & Expeditions-Kreuzfahrten

www.cruiselounge.ch



the
SENSE
of
ADVENTURE

2026 WORLD CRUISE



The flavours of a perfectly prepared Pad Thai compel you to taste more of Thai culture. A cooling breeze carries the aroma of a verdant countryside after a tropical rain, reminding you of your first trip to Hawaii. The way the light pierces a tree canopy as the sun rises in the East draws you further down that dusty road. That song that played on your first taxi ride in Europe brings a smile to your face as you recall your early days of exploration.

With echoes of memory and whispers of desire, our senses call to us. And for those enchanted by the love of travel, the sense of adventure calls the loudest.

Answer the call and indulge your wanderlust aboard an unforgettable, all-inclusive journey that is certain to stir your soul. Venture forth from Miami aboard the ever elegant *Seven Seas Mariner*® on a full circumnavigation of the globe in 2026. Spend 154 nights in luxurious exploration of three oceans, six continents, over 41 countries and more than 77 ports of call with 16 in-port overnights and hundreds of shore excursions. Join us to engage and explore to your hearts content, creating an adventure all your own as we navigate the world together.

The Sense of Adventure calls. Will you answer?

EVERY LUXURY INCLUDED™



Our unrivalled experience encompasses every luxury amenity you can imagine

included

UNLIMITED SHORE EXCURSIONS

included

UNLIMITED DRINKS, INCLUDING FINE WINES AND SPIRITS

included

PRE-PAID GRATUITIES

included

SPECIALITY RESTAURANTS

included

VALET LAUNDRY SERVICE

included

UNLIMITED WIFI

included

TRANSFER BETWEEN AIRPORT TO HOTEL AND HOTEL TO SHIP*

included

ALL 2026 WORLD CRUISE BESPOKE AMENITIES*

*Please see full bespoke amenities list. Terms and conditions apply. Visit [RSSC.com](https://www.rssc.com)

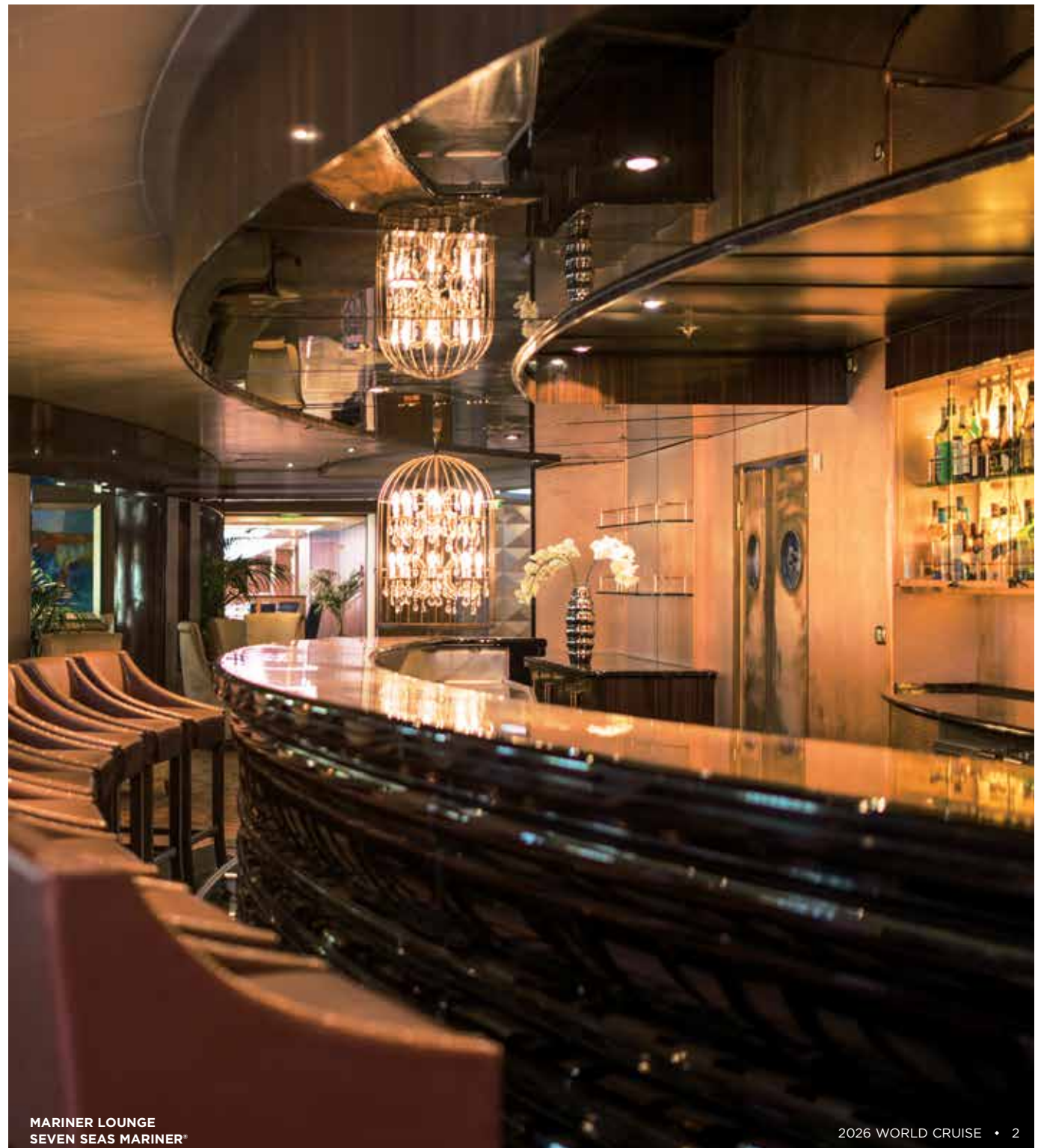



2026 WORLD CRUISE
 THE SENSE OF ADVENTURE

on Seven Seas Mariner®

ROUNDTRIP MIAMI | 154 NIGHTS | 10 JANUARY 2026



3 OCEANS CRUISED | **15** SEAS, STRAITS, GULFS, BAYS & CHANNELS CRUISED | **6** CONTINENTS | **41** COUNTRIES | **77** PORTS OF CALL
16 OVERNIGHT STAYS | **47** UNESCO WORLD HERITAGE SITES | **431** INCLUDED SHORE EXCURSIONS | **39,722** NAUTICAL MILES SAILED

THE SENSE OF ADVENTURE

on Seven Seas Mariner®

ROUNDRIP MIAMI | 154 NIGHTS | 10 JANUARY 2026

UP TO 431 INCLUDED SHORE EXCURSIONS

DATE	PORT	ARRIVE	DEPART
10 Jan	Miami, Florida 	12:00	
	PRE-CRUISE GALA EVENT ★	<i>Embark</i>	
11	Miami, Florida		16:00
12	Cruising the Florida Straits		
13	Cruising the Caribbean Sea		
14	Cartagena, Colombia	09:00	14:00
15	Panama Canal Transit		
16	Cruising the Pacific Ocean		
17	Puntarenas, Costa Rica	07:00	16:00
18	Corinto, Nicaragua	10:00	19:00
19	Puerto Quetzal, Guatemala	10:00	20:00
20	Cruising the Pacific Ocean		
21	Acapulco, Mexico	07:00	16:00
22	Cruising the Pacific Ocean		
23	Cabo San Lucas, Mexico	07:00	15:00
24	Cruising the Pacific Ocean		
25	Cruising the Pacific Ocean		
26	Cruising the Pacific Ocean		
27	Cruising the Pacific Ocean		
28	Cruising the Pacific Ocean		
29	Hilo, Hawaii	11:00	20:00
30	Kahului, Hawaii	08:00	19:00
31	Honolulu, Hawaii  ★ <i>A Taste of History</i>	07:00	
1 Feb	Honolulu, Hawaii		21:00
2	Nawiliwili, Hawaii 	08:00	
3	Nawiliwili, Hawaii		18:00
4	Lahaina, Hawaii	07:00	14:00
5	Cruising the Pacific Ocean		
6	Cross the International Date Line (Lose a Day)		
7	Cruising the Pacific Ocean		
8	Tabuaeran (Fanning Island), Kiribati 	08:00	18:00
9	Cruising the South Pacific		
9	Cross the International Date Line (Gain a Day)		
9	Cruising the South Pacific		
10	Cruising the South Pacific		
11	Rangiroa, French Polynesia	07:00	17:00
12	Raiatea, French Polynesia	09:00	21:00
13	Bora Bora, French Polynesia 	07:00	
14	Bora Bora, French Polynesia		17:00
15	Papeete (Tahiti),  French Polynesia	06:00	
16	Papeete (Tahiti), French Polynesia		05:00

DATE	PORT	ARRIVE	DEPART
16	Moorea, French Polynesia	08:00	18:00
17	Huahine, French Polynesia	07:00	16:00
18	Cruising the South Pacific		
19	Cruising the South Pacific		
20	Pago Pago, American Samoa	10:00	19:00
21	Cross the International Date Line (Lose a Day)		
22	Apia, Samoa	08:00	18:00
23	Cruising the South Pacific		
24	Suva, Fiji	09:00	19:00
25	Lautoka, Fiji	08:00	18:00
26	Cruising the South Pacific		
27	Port Vila (Efate), Vanuatu	08:00	18:00
28	Lifou Island, New Caledonia 	08:00	18:00
1 Mar	Maré, New Caledonia 	07:00	17:00
2	Nouméa, New Caledonia	07:00	17:00
3	Cruising the South Pacific		
4	Cruising the South Pacific		
5	Auckland, New Zealand 	09:00	
6	Auckland, New Zealand		19:00
7	Bay of Islands, New Zealand	07:00	16:00
8	Cruising the Tasman Sea		
9	Cruising the Tasman Sea		
10	Sydney, Australia 	10:00	
11	Sydney, Australia		18:00
12	Cruising the Tasman Sea		
13	Mooloolaba, Australia	07:00	18:00
14	Cruising the Coral Sea		
15	Whitsunday Island (Airlie Beach), Australia	07:00	16:00
16	Cairns, Australia	09:00	16:00
17	Cruising the Coral Sea		
18	Cruising the Arafura Sea		
19	Darwin, Australia 	17:00	
20	Darwin, Australia		19:00
21	Cruising the Timor Sea		
22	Waingapu (Sumba), Indonesia 	09:00	17:00
23	Bali (Benoa), Indonesia  ★ <i>Across the Archipelago</i>	12:00	
24	Bali (Benoa), Indonesia		21:00
25	Bali (Celukan Bawang), Indonesia	07:00	18:00
26	Surabaya, Indonesia	08:00	17:00
27	Semarang (Java), Indonesia	07:00	16:00

DATE	PORT	ARRIVE	DEPART
28	Cruising the Java Sea		
29	Cruising the South China Sea		
30	Ho Chi Minh City, Vietnam 	13:00	
31	Ho Chi Minh City, Vietnam		16:00
1 Apr	Nha Trang, Vietnam	10:00	19:00
2	Cruising the South China Sea		
3	Sihanoukville, Cambodia	08:00	17:00
4	Bangkok (Laem Chabang),  Thailand	10:00	
5	Bangkok (Laem Chabang), Thailand		18:00
6	Ko Samui, Thailand	09:00	18:00
7	Cruising the Gulf of Thailand		
8	Singapore 	09:00	
9	Singapore		17:00
10	Kuala Lumpur (Port Klang), Malaysia	09:00	19:00
11	Langkawi, Malaysia	10:00	19:00
12	Phuket, Thailand	07:00	17:00
13	Cruising the Andaman Sea		
14	Cruising the Laccadive Sea		
15	Galle, Sri Lanka	09:00	19:00
16	Colombo, Sri Lanka	06:00	15:00
17	Cochin (Kochi), India	11:00	20:00
18	Mangalore, India	10:00	19:00
19	Goa (Mormugao), India	07:00	17:00
20	Cruising the Laccadive Sea		
21	Malé, Maldives	10:00	19:00
22	Cruising the Arabian Sea		
23	Cruising the Arabian Sea		
24	Cruising the Arabian Sea		
25	Praslin, Seychelles	07:00	15:00
25	Mahé, Seychelles 	18:00	
26	Mahé, Seychelles		16:00
27	Cruising the Indian Ocean		
28	Nosy Be, Madagascar	09:00	17:00
29	Mayotte, French Comoros	07:00	16:00
30	Cruising the Mozambique Channel		
1 May	Cruising the Mozambique Channel		
2	Maputo, Mozambique	10:00	20:00
3	Richards Bay, South Africa 	13:00	
4	Richards Bay, South Africa		22:00
5	Durban, South Africa	07:00	18:00
6	Cruising the Indian Ocean		
7	Mossel Bay, South Africa	07:00	17:00

DATE	PORT	ARRIVE	DEPART
8	Cape Town, South Africa 	09:00	
9	Cape Town, South Africa		17:00
10	Cruising the Atlantic Ocean		
11	Walvis Bay, Namibia 	12:00	
12	Walvis Bay, Namibia		18:00
13	Cruising the Atlantic Ocean		
14	Cruising the Atlantic Ocean		
15	Luanda, Angola	08:00	18:00
16	Cruising the Atlantic Ocean		
17	São Tomé, São Tomé & Príncipe	10:00	19:00
18	Cruising the Gulf of Guinea		
19	Cotonou, Benin	07:00	17:00
20	Sekondi-Takoradi, Ghana	10:00	20:00
21	Abidjan, Ivory Coast	07:00	16:00
22	Cruising the Atlantic Ocean		
23	Cruising the Atlantic Ocean		
24	Dakar, Senegal	11:00	21:00
25	Cruising the Atlantic Ocean		
26	Mindelo (São Vicente), Cape Verde	07:00	18:00
27	Cruising the Atlantic Ocean		
28	Cruising the Atlantic Ocean		
29	Santa Cruz de la Palma, Canary Islands	07:00	17:00
30	Funchal (Madeira), Portugal	09:00	18:00
31	Cruising the Atlantic Ocean		
1 Jun	Lisbon, Portugal	06:00	19:00
	★ <i>Passport to Portuguese Flavour</i>		
2	Cruising the Atlantic Ocean		
3	Cruising the Atlantic Ocean		
4	Horta (Azores), Portugal	08:00	18:00
5	Cruising the Atlantic Ocean		
6	Cruising the Atlantic Ocean		
7	Cruising the Atlantic Ocean		
8	Cruising the Atlantic Ocean		
9	Hamilton, Bermuda	08:00	18:00
10	Cruising the Atlantic Ocean		
11	Cruising the Atlantic Ocean		
12	Great Stirrup Cay, Bahamas	08:00	19:00
13	Miami, Florida	08:00	
	<i>Debar</i>		

 Overnight in port  NEW PORT OF CALL

★ *Included Shoreside Experiences*

*See Terms & Conditions for full details.



2026 WORLD CRUISE

INCLUDED BESPOKE AMENITIES*

1-NIGHT PRE-CRUISE LUXURY HOTEL
PACKAGE IN MIAMI

★ EXCLUSIVE PRE-CRUISE GALA EVENT

★ EXCLUSIVE SHORESIDE EXPERIENCE
A Taste of History
Honolulu, Hawaii

★ EXCLUSIVE SHORESIDE EXPERIENCE
Across the Archipelago
Bali, Indonesia

★ EXCLUSIVE SHORESIDE EXPERIENCE
Passport to Portuguese Flavour
Lisbon, Portugal

US\$600 SHIPBOARD CREDIT PER PERSON*

UNLIMITED VALET LAUNDRY,
INCLUDING DRY CLEANING & PRESSING

PHONE TIME PER SUITE

ONBOARD MEDICAL SERVICE

COMMEMORATIVE GIFT

FOR MORE DETAILS
CONTACT YOUR TRAVEL ADVISOR

SUITE CATEGORIES	EURO FARE PER PERSON
MS MASTER SUITE	245,369€
GS GRAND SUITE	216,669€
MN MARINER SUITE	186,119€
SS SEVEN SEAS SUITE	162,499€
HS HORIZON VIEW SUITE	137,969€
A PENTHOUSE SUITE	131,489€
B PENTHOUSE SUITE	127,319€
C PENTHOUSE SUITE	123,149€
D CONCIERGE SUITE	96,209€
E CONCIERGE SUITE	93,799€
F DELUXE VERANDA SUITE	91,389€
G DELUXE VERANDA SUITE	88,989€
H DELUXE VERANDA SUITE	86,579€

Fares are per person, based on double occupancy

+ SEVEN SEAS SOCIETY® MEMBERS ENJOY SAVINGS
OF UP TO 7 410€ PER SUITE

+ PAST WORLD CRUISE GUESTS ENJOY ADDITIONAL
SAVINGS OF UP TO 7 410€ PER SUITE

THAT'S A TOTAL SAVING OF UP TO 14 820€ PER SUITE*

*Savings are based on double occupancy

PRE-REGISTER NOW & REQUEST YOUR PREFERRED SUITE

CONTACT YOUR TRAVEL ADVISOR
WORLD CRUISE OPENS FOR BOOKINGS ON 22 MARCH 2023





2026
WORLD CRUISE

Exclusive

SHORESIDE EXPERIENCES

A TASTE OF HISTORY AT THE BATTLESHIP MISSOURI

31 January 2026 | Honolulu, Hawaii

Tour the historic Battleship Missouri on an exclusive shoreside experience where you'll see, feel and learn about the monumental events 'Mighty Mo' endured, from the official surrender of Japan in World War II until today. While aboard, savour the culture of these vibrant islands with traditional fare that includes unique tropical dishes enhanced over the years by various and flavourful influences. It will be an evening you won't soon forget.

ACROSS THE ARCHIPELAGO DINNER AT GARUDA WISNU KENCANA

23 March 2026 | Bali, Indonesia

Bali is known for its natural beauty, and Garuda Wisnu Kencana does not disappoint. Experience the magic of this breathtaking park at unforgettable World Cruise dining event in Lotus Pond. Surrounded by rock walls adorned by lush foliage, you'll experience a sensory journey across the archipelago through live performances alongside an array of culinary delights sampling the incredible cultures that coincide in this stunning destination.

PASSPORT TO PORTUGUESE FLAVOUR AT CONVENTO DO BEATO

1 June 2026 | Lisbon, Portugal

Feel the rhythms and taste the beauty of Portugal on this exclusive shoreside event. Move through five different regions of Portugal via their distinctive flavour palates on a culinary journey sampling everything from regional wines to main dishes, local cheeses to produce, and delectable desserts. And for the perfect pairing in this beautiful venue, you'll enjoy the sights and sounds of a live Fado performance moving you throughout the evening.

Seven Seas Mariner® SUITES



MASTER SUITE CATEGORY MS

186 m². Suite: 112 m² | Side Balcony: 6 m²
Forward Balcony: 68 m²
Suite includes 2 spacious bedrooms, 2½ marble bathrooms
and 2 private balconies



GRAND SUITE CATEGORY GS

92 m². Suite: 84 m² | Balcony: 8 m²
Suite includes 1 spacious bedroom and 2 marble bathrooms

AMENITIES FOR MASTER SUITE & GRAND SUITE INCLUDE:

- ◆ Dinner with a Senior Officer
- ◆ Guaranteed Reservation Each Night in a Speciality Restaurant of Your Choice
- ◆ In-Suite Dining Menu Including Speciality Restaurant Selections During Dining Hours
- ◆ Priority Boarding on Embarkation Day with Suite Access at 12:00

- ◆ Complimentary 25-Minute Personal Fitness Session at the Serene Spa & Wellness™ Fitness Centre
- ◆ Complimentary In-Suite Cocktail Party for 8
- ◆ Guerlain Box with Fragrance & Spongellé Buffer
- ◆ Tea Forté Set-Up

Plus All Amenities Listed in Mariner Suites



MARINER SUITE CATEGORY MN

69 m². Suite: 61 m² | Balcony: 8 m²
Suite includes 1 spacious bedroom and 1½ marble bathrooms

AMENITIES INCLUDE:

- ◆ Welcome Bottle of Veuve Clicquot
- ◆ Personalised In-Suite Full-Liquor Bar Set-Up
- ◆ A Sumptuous In-Suite Caviar Service Once During Cruise
- ◆ Delivery of up to 3 Daily Newspapers & World Atlas

Plus All Amenities Listed in Seven Seas Suites



SEVEN SEAS SUITE CATEGORY SS

AFT: 79 m². Suite: 52 m² | Balcony: 27 m²
FORWARD: 56 m². Suite: 47 m² | Balcony: 9 m²
Suite includes 1 spacious bedroom; Seven Seas Suite Aft includes 1½ marble bathrooms

AMENITIES INCLUDE:

- ◆ Acqua di Parma Bath Amenities
- ◆ Selection of Fig & Tea Leaves Bath Salts
- ◆ Priority Boarding on Embarkation Day with Suite Access at 13:00

Plus All Amenities Listed in Horizon View Suites

Seven Seas Mariner® SUITES



HORIZON VIEW SUITE CATEGORY HS

58 m². Suite: 33 m² | Balcony: 25 m²
Suite includes 1 spacious bedroom

AMENITIES INCLUDE:

- ◆ Luxe Fruit Arrangement
- ◆ Suite Access on Embarkation Day at 13:00

Plus All Amenities Listed in Penthouse Suites



PENTHOUSE SUITE CATEGORY A-C

42 m². Suite: 35 m² | Balcony: 7 m²

AMENITIES INCLUDE:

- ◆ Personal Butler Committed to Fulfilling Your Wishes
- ◆ Daily Canapés
- ◆ Guerlain Bath Amenities & Men's Unscented Shaving Kit
- ◆ Bose® SoundLink Mini II Bluetooth Speaker
- ◆ In-Suite Windows® Tablet
- ◆ Selection of Bed Pillow Styles
- ◆ Complimentary Garment Pressing on First Night
- ◆ Personalised Stationery

Plus All Amenities Listed in Concierge Suites



CONCIERGE SUITE CATEGORY D & E

28 m². Suite: 23 m² | Balcony: 5 m²

AMENITIES INCLUDE:

- ◆ Priority Online Shore Excursion & Speciality Dining Reservations
- ◆ Binoculars, illy® Espresso Maker & Cashmere Blankets
- ◆ Complimentary Tote Bag

Plus All Amenities Listed in Deluxe Veranda Suites



DELUXE VERANDA SUITE CATEGORY F-H

28 m². Suite: 23 m² | Balcony: 5 m²

AMENITIES INCLUDE:

- ◆ Valet Laundry Service
- ◆ Welcome Bottle of Champagne & Fresh Fruit
- ◆ Private Balcony
- ◆ Sitting Area
- ◆ Marble & Stone Detailed Bathroom
- ◆ European King-Size Elite Slumber™ Bed
- ◆ In-Suite Minibar Set-Up & Refill
- ◆ 24-Hour Room Service
- ◆ Shoe Shine Service
- ◆ Interactive Flat-Screen Television & Direct-Dial Satellite Phone
- ◆ L'Occitane® Jasmin & Bergamote Bath Amenities
- ◆ Regent Bathrobe & Slippers
- ◆ Walk-In Closet with Safe
- ◆ Vanity & Hair Dryer

Seven Seas Mariner® DECK PLANS

★ Bathroom features a glass-enclosed shower instead of bathtub

♿ Wheelchair accessible suites 828, 829, 918, 919, 1012 and 1013 have shower stall instead of bathtub

+ 2-bedroom suite accommodates up to 6 guests (Up to one rollaway bed can be added to most suites, please enquire at time of booking)

● Convertible sofa bed

- MS MASTER SUITE
- GS GRAND SUITE
- MN MARINER SUITE
- SS SEVEN SEAS SUITE
- HS HORIZON VIEW SUITE
- A PENTHOUSE SUITE
- B PENTHOUSE SUITE
- C PENTHOUSE SUITE
- D CONCIERGE SUITE
- E CONCIERGE SUITE
- F DELUXE VERANDA SUITE
- G DELUXE VERANDA SUITE
- H DELUXE VERANDA SUITE

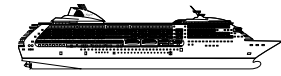

OVERALL LENGTH 216.1 m
 BEAM (WIDTH) 28.3 m
 DRAFT 6.4
 SUITES 348
 GUESTS 696
 CREW 467 International
 GUEST DECKS 8
 GROSS TONNAGE 48,075
 CRUISING SPEED 20 Knots
 SHIP'S REGISTRY Bahamas

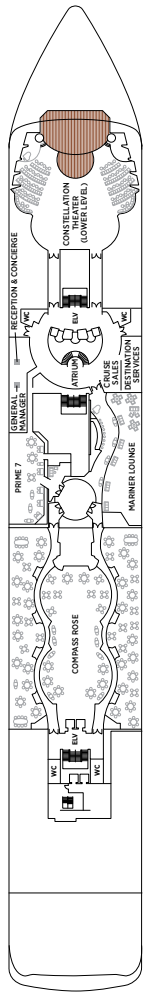

DECK 5

COMPASS ROSE
 CONSTELLATION THEATER (LOWER)
 CRUISE SALES
 DESTINATION SERVICES
 MARINER LOUNGE
 PRIME 7
 RECEPTION & CONCIERGE

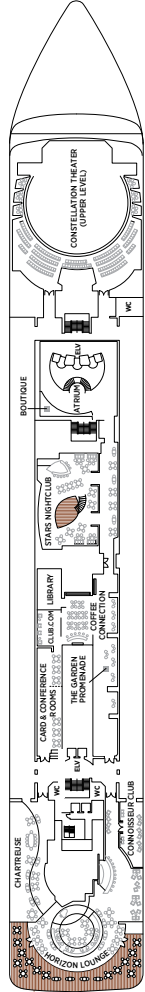

DECK 6

BOUTIQUE
 CARD & CONFERENCE ROOMS
 CHARTREUSE
 COFFEE CONNECTION
 CONNOISSEUR CLUB
 CONSTELLATION THEATER (UPPER)
 THE GARDEN PROMENADE
 HORIZON LOUNGE
 LIBRARY / CLUB.COM
 STARS NIGHTCLUB

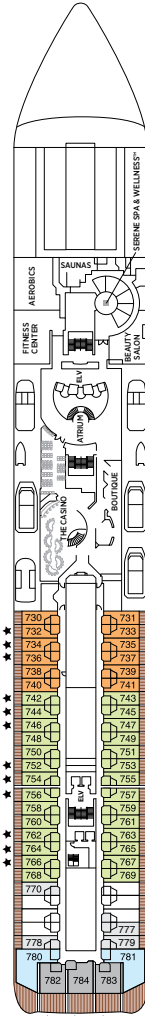

DECK 7

AEROBICS
 BEAUTY SALON
 BOUTIQUE
 THE CASINO
 FITNESS CENTER
 SAUNAS
 SERENE SPA & WELLNESS™

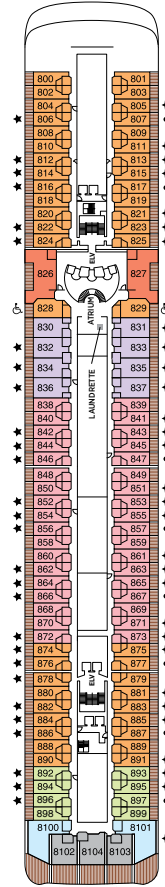

DECK 8

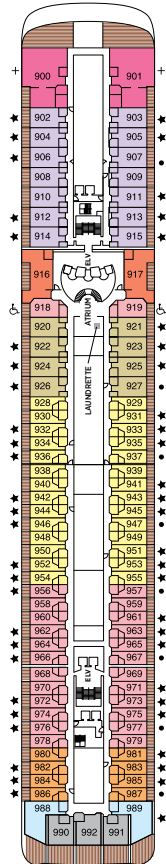

DECK 9

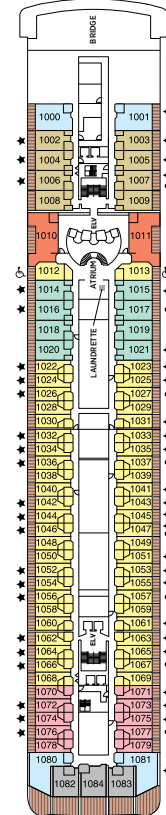

DECK 10

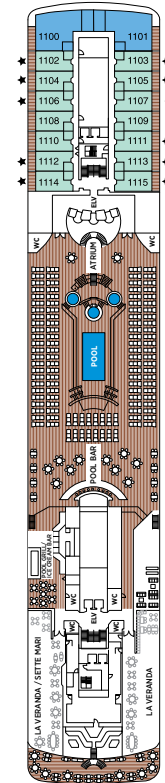

DECK 11

LA VERANDA
 ICE CREAM BAR
 POOL BAR
 POOL DECK
 POOL GRILL
 SETTE MARI

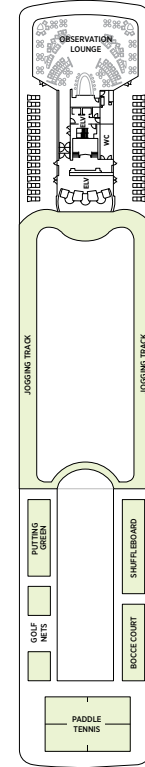

DECK 12

BOCCE COURT
 GOLF NETS
 JOGGING TRACK
 OBSERVATION LOUNGE
 PADDLE TENNIS COURT
 PUTTING GREEN
 SHUFFLEBOARD
 SPORTS DECK

TERMS & CONDITIONS

NOTIFICATION Information contained in this brochure is not an offer or a contract. The transportation of Guests and baggage on Regent Seven Seas Cruises® vessels is provided solely by the Operator and is governed by the Terms and Conditions of the Guest Ticket Contract. For complete information on Terms and Conditions, itineraries, liability of Regent Seven Seas Cruises® and all sections mentioned below, please refer to the Guest Ticket Contract. A copy of the Guest Ticket Contract is available by contacting your Travel Advisor or online at RSSC.com. Upon booking the cruise, all of the Terms and Conditions of the Guest Ticket Contract shall be binding on the parties thereto.

DEPOSIT & PAYMENTS | 154-NIGHT 2026 WORLD CRUISE - THE SENSE OF ADVENTURE The per person deposit to secure your 154-Night 2026 World Cruise The Sense of Adventure is 20% of the applicable cruise fare for all suites and must be received within seven days of booking. Final balance must be received no later than 42 days prior to cruise departure, together with passport details and any special onboard service requests; otherwise, booking may be subject to immediate cancellation and any applicable penalties. American Express, MasterCard, Visa, credit cards and Wire Transfers are acceptable forms of payment for deposits and full payments. For your convenience, your Final Payment may be automatically charged to the credit card used to make the initial deposit. Regent Seven Seas Cruises® accepts no responsibility for credit card foreign currency/transaction processing fees independently assessed by issuing banks. None of these fees separately charged by the issuing banks accrues to the benefit of Regent Seven Seas Cruises®. Third party credit card charges can only be accepted when accompanied by valid authorisation to charge from the relevant card owner.

CANCELLATION & REFUNDS A 95% cancellation fee will be imposed as indicated for non-appearance. Fare is defined as the full cost of any cruise or air component purchased from Regent Seven Seas Cruises®, excluding optional facilities and services fees. Please refer to the full Terms and Conditions of the Guest Ticket Contract for fees relating to the cancellation of optional facilities and services. Any refund due, as indicated by the cancellation fee schedule, will be made after receipt of written notice of cancellation. Cancellation notices must be in writing and received by Regent Seven Seas Cruises® no later than the day before cancellation penalties are to be assessed. Guests who cancel within the indicated periods are subject to the following per person cancellation fees:

2026 WORLD CRUISE - THE SENSE OF ADVENTURE

DAYS PRIOR TO SAILING	CANCELLATION AMOUNT PER PERSON
Deposit Date to 181 days	200€ per guest
180-121	20% of fare
120-75	35% of fare
74-42	50% of fare
41-8	75% of fare
7-0	95% of fare

INSURANCE We highly recommend adequate personal and baggage insurance and trip cancellation insurance to cover the full purchase price of the cruise, including air and/or land programme costs. All trip cancellation policies will be strictly enforced. No refund will be made for unused or partially used portions of the cruise, air or land programmes, including shore excursions, except as specifically outlined in the Guest Ticket Contract.

PREGNANCY, CHILDREN, INFANTS & UNACCOMPANIED MINORS Regent Seven Seas Cruises® cannot accept Guests who will have entered their 24th week of pregnancy at the beginning of, or at any time during, the cruise. Infants must be 6 (six) months of age as of the first day of the cruise. Guests travelling with a young infant that does not meet the infant policy will be denied boarding. No refunds or other compensation shall be due from Regent Seven Seas Cruises® as a result of the denial of boarding to an underage infant or any accompanying Guests. Any Guest under the age of 18 must be accompanied by and occupy the same stateroom as an adult 18 years or older. Regent Seven Seas Cruises® does not provide for the care, entertainment or supervision of children.

ITINERARY Guests acknowledge that the scheduled itinerary is subject to delay, modification, or port of call cancellation due to weather and other causes beyond the control of Regent Seven Seas Cruises®. If necessary, at the sole discretion of Regent Seven Seas Cruises®, Regent Seven Seas Cruises® may substitute ports of call or make itinerary changes. Regent Seven Seas Cruises® does not assume responsibility or liability for any loss or expense incurred by Guests as a result of any changes or cancellations. Please refer to the full terms and conditions of the Guest Ticket Contract.

RESPONSIBILITY Regent Seven Seas Cruises® accepts no liability, whether occasioned by rail, coach, private car, boat, aircraft or any other conveyance, for any injury, damages, loss, accident or delay from the acts or defaults of any company or person, or in carrying

out the arrangements of the cruise or cruise tour, as a result of any cause beyond the control of Regent Seven Seas Cruises®. Guests specifically release Regent Seven Seas Cruises® from any and all claims for loss or damage to baggage or property, or from personal injuries or death, or from loss from delay, arising out of the acts, omissions or negligence of any other party, such as air carriers, hotels, shore excursion operators, restaurateurs, transportation providers, medical personnel, ship owners, ship operators or other providers of services and facilities. All medical services and independent contractor services are provided solely for the convenience of Guests and are done at the Guest's own risk and cost. Please refer to the full terms and conditions of the Guest Ticket Contract.

NOTICE While Regent Seven Seas Cruises® makes every effort to adhere to the specifics shown in this brochure, circumstances may require otherwise. All information contained herein is subject to change without notice at the discretion of Regent Seven Seas Cruises®. All schedules and fares listed in this brochure are subject to change without notice. Regent Seven Seas Cruises® is not responsible or liable for any typographical errors, omissions or misprints. Please refer to the full terms and conditions of the Guest Ticket Contract which are binding upon the Guest.

FARES & SPECIAL OFFERS *Fares are subject to increase. All fares are per person in Euros, based on double occupancy (unless otherwise noted), for new bookings only and may be withdrawn at any time. INCLUDED Medical Service includes onboard medically necessary treatment only and does not include port-specific testing requirements. Bespoke Amenities apply to World Cruise Guests on full 154-Night 2026 World Cruise - The Sense of Adventure. Phone inclusion is per the standard Seven Seas Society® programme on World Cruise. For full Terms & Conditions please visit RSSC.com. Ship's Registry: Bahamas. © 2023 Regent Seven Seas Cruises®.

Bespoke_WorldCruise2026_EBook_DE



CRUISE  LOUNGE
Luxus- & Expeditions-Kreuzfahrten

Regent

SEVEN SEAS CRUISES®

AN UNRIVALLED EXPERIENCE™

*within every traveller exists a yearning
for a journey so epic, it stirs the soul*

Join us and embrace

THE SENSE OF ADVENTURE

with Every Luxury Included™

Exclusive Shoreside Experiences

Exclusive World Cruise Amenities and Gifts

Special Onboard Events

Pre-Cruise Gala *and more...*

Cruise Lounge by TCTT GmbH
Seefeldstr. 128 - 8008 Zürich
044 260 22 88 - info@tctt.ch
www.cruiseloung.ch - www.tctt.ch